

BRExhaust™

A **MAGNAFLOW** GROUP COMPANY

INSTALLATION INSTRUCTIONS | PART NO. 106-0661

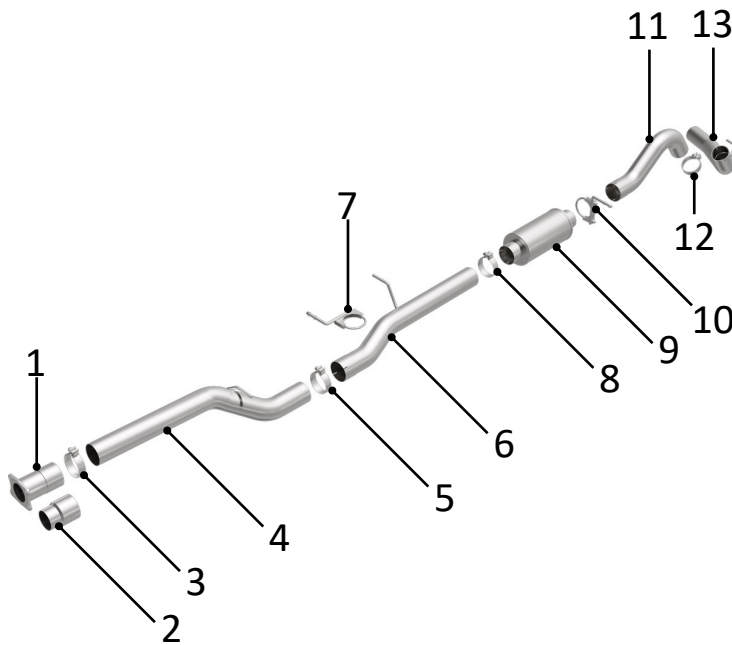

STEP 1: (Carefully read all instructions before installation) Disconnect the vehicle's battery before removal of the OEM exhaust system. This will prevent electrical accidents and will reset the computer if it applies to the vehicle. Remove existing exhaust system from the vehicle. Only remove parts that will be replaced. Clean existing flange with a wire brush to ensure proper sealing.

STEP 2: Remove the OEM system by unfastening the inlet. For 2001-2005 vehicles unbolt the inlet flange. For 2006-2007.5 vehicles loosen the slip clamp. Disengage the hangers from the isolators working rearward. You may need to cut the OEM system to ease the removal process. Do not damage or discard the OEM fasteners and isolators, as they will be reused to mount the new system.

STEP 3: For 2001-2005 vehicles attach **[1] Inlet Pipe Assembly** to existing exhaust reusing existing hardware.

For 2006-2007.5 vehicles attach **[2] Inlet Pipe** to existing exhaust reusing existing hardware.

STEP 4: Trim, if necessary, **[4] Front Pipe Assembly** by measuring and cutting from the inlet end then attach to existing isolator and selected **Inlet Pipe** with supplied **[3] Clamp**.

2001-2005 Extended Cab vehicles trim 9in.

2001-2005 Crew Cab vehicles no trimming is required

2006-2007.5 Extended Cab vehicles trim 11in.

2006-2007.5 Crew Cab vehicles trim 4in.

STEP 5: For Short Bed vehicles trim 13in. from the **[6] Intermediate Pipe Assembly** by measuring and cutting from the outlet end. Slide **[7] Hanger Clamp** over **[6] Intermediate Pipe Assembly** and attach to **[4] Front Pipe Assembly** with supplied **[5] Clamp**. Attach **[7] Hanger Clamp** to existing isolator, the welded hanger on **[6] Intermediate Pipe Assembly** will not be used.

For non Short Bed vehicles attach **[6] Intermediate Pipe Assembly** to existing isolator and **[4] Front Pipe Assembly** with supplied **[5] Clamp**.

STEP 6: Attach **[9] Muffler** to **[6] Intermediate Pipe Assembly** with supplied **[8] Clamp**.

STEP 7: Attach **[11] Over-Axle Pipe** to existing isolator and **[9] Muffler** with supplied **[10] Hanger Clamp**.

STEP 8: Attach **[13] Tailpipe Assembly** to existing isolator and **[11] Over-Axle Pipe** with supplied **[12] Clamp**.

STEP 9: Once a final position has been chosen for the new exhaust system, evenly tighten all clamps from front to rear using the torque specifications on page one of the instructions. Inspect all fasteners after 25-50 miles of operation and re-tighten if necessary.

WARNING:

When working on, under, or around any vehicle exercise caution. Please allow the vehicle's exhaust system to cool before removal, as exhaust temperatures may cause severe burns. If working without a lift, always consult vehicle manual for correct lifting specifications. Always wear safety glasses and ensure a safe work area. Serious injury or death could occur if safety measures are not followed.



BRExhaust recommends
professional installation
for all products

Technical Support: 1-800-631-7271

BRExhaust — 1901 Corporate Ctr, Oceanside, CA 92056

www.brexhaust.com

BRExhaust™

A **MAGNAFLOW** GROUP COMPANY

CUT TO FIT INSTALLATION INSTRUCTIONS

DESIGN TABLE

DESIGN STYLE 1: CUT TO FIT INTERMEDIATE PIPE

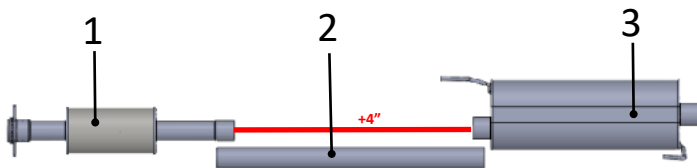

DESIGN STYLE 2: CUT TO FIT INLET

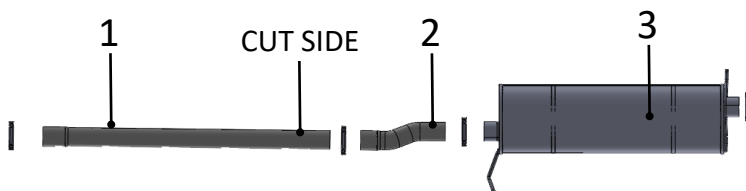

DESIGN STYLE 3: CUT TO FIT TAIL PIPE

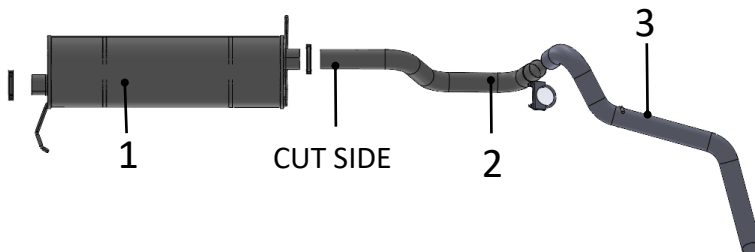

WARNING:

When working on, under, or around any vehicle exercise caution. Please allow the vehicle's exhaust system to cool before removal, as exhaust temperatures may cause severe burns. If working without a lift, always consult vehicle manual for correct lifting specifications. Always wear safety glasses and ensure a safe work area. Serious injury or death could occur if safety measures are not followed.

MATCH PURCHASED KIT'S CUT TO FIT DESIGN TO GRAPHIC IN DESIGN TABLE

DESIGN STYLE 1

STEP 1:

Attach item 1 to existing exhaust

STEP 2:

Attach item 3 to existing isolators

STEP 3:

Cut item 2 4" longer than the distance between the installed parts, this will allow for a 2" overlap for each slip fit (**cutting part too short will increase likelihood of leaks**)

DESIGN STYLE 2

STEP 1:

Attach item 3 to existing isolators

STEP 2:

Attach item 2 to item 3

STEP 3:

Cut item 2 2" longer than the distance between item 2 and OEM part, this will allow for a 2" overlap (**cutting part too short will increase likelihood of leaks**)

DESIGN STYLE 3

STEP 1:

Attach item 1 to existing isolators

STEP 2:

Attach item 3 to existing isolators



BRExhaust recommends
professional installation
for all products

Technical Support: 1-800-631-7271

BRExhaust — 1901 Corporate Ctr, Oceanside, CA 92056

www.brexhaust.com